



COMUNE DI FOLIGNO  
PIANO ATTUATIVO L.R. 31/97

LOCALITA'  
COLLE DI VERCHIANO

GRUPPO DI LAVORO:  
Arch. Marcello Marchetti - Arch. Francesco Ripa - Ing. Guglielmo Bernini - Ing. Walter Pini  
Arch. Fabio Corbelli - Cons. Donato Baccarelli - Cons. Roberto Fabbri - Cons. Ernesto Galbiati  
Arch. Marcello Marchetti - Cons. Giuseppe  
**gruppo 08**

Rapp. di scala 1:200

PERIMETRAZIONE N°  
**18**

TAVOLA  
**2**



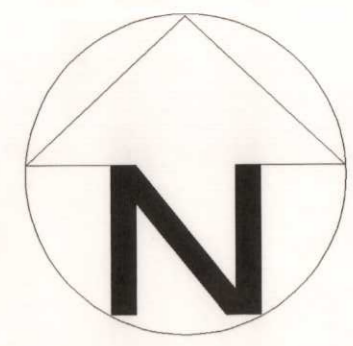
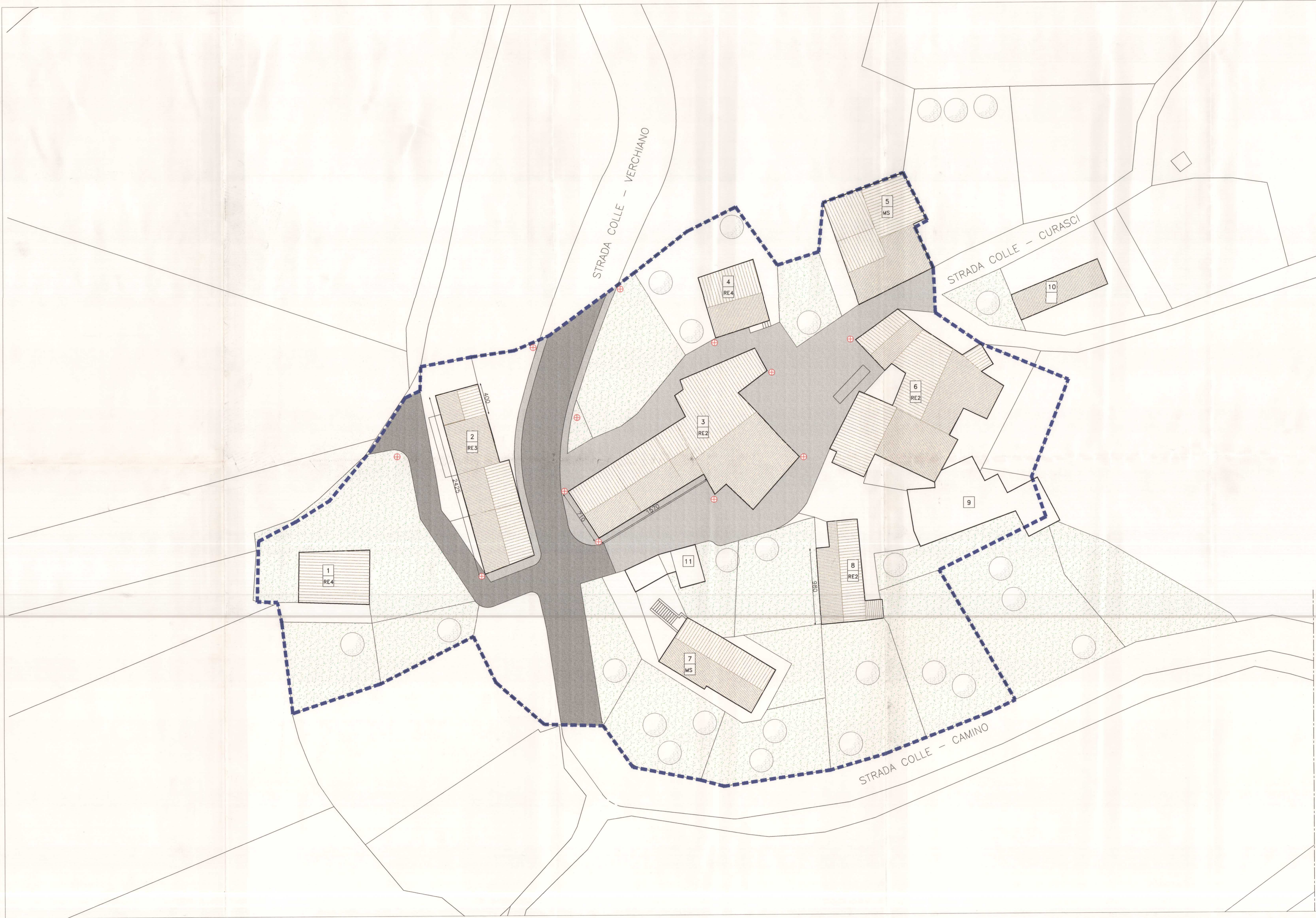

DATA 10/11/98

APPROVATO CON DELIBERA N. 45 del 08 APRILE 1999

PLANIMETRIA GENERALE - PROGETTO

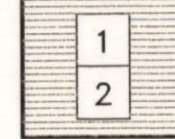
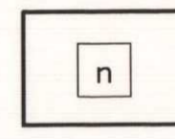

LEGENDA

-  area interessata dal Piano Attuativo
-  1 - numero U.M.I.  
2 - categoria di intervento
-  n - U.M.I. con assenza di danno
-  strada asfaltata
-  pavimentazione in ciottolato
-  verde privato
-  punto luce illuminazione pubblica