

REGIONE DELL'UMBRIA

L.R. 11.04.1997 N. 13
D.C.R. 08.11.1999 N. 735

CITTA' DI FOLIGNO

P.U.C. FORNACI HOFFMANN PIANO PARTICOLAREGGIATO ATTUATIVO in variante al P.R.G.

RILIEVO FOTOGRAFICO

tavola

R0

P.P.A.

SERVIZI ED ELABORAZIONI INFORMATICHE: SINTAGMA srl & LUCCIONIARCHSTUDIO Architecture Design Town Plan

REVISIONE	DATA	OGGETTO	REDATTO	APPROVATO	AUTORIZZATO
0	19.09.01	EMISSIONE	LUCCIONI <i>P. Luccioni</i>	SOTGIU	BRACCHINI <i>P. Bracchini</i>

PROGETTO

ARCH. ALESSANDRO BRACCHINI
ARCH. PAOLO LUCCIONI
ING. FEDERICO SOTGIU

P. Luccioni

COLLABORATORI

ARCH. BARBARA BAGAGLIA
ARCH. GIANLUIGI NOVELLO
ARCH. NICOLANGELO RUSSO
LORETTA DELLA BOTTE
ANDREA SPICCALLUNTO

IL SINDACO

DOTT. MAURIZIO SALARI

COORDINAMENTO UFFICIO URBANISTICA

ARCH. LUCIANO PIERMARINI

NUMERAZIONE EDIFICI

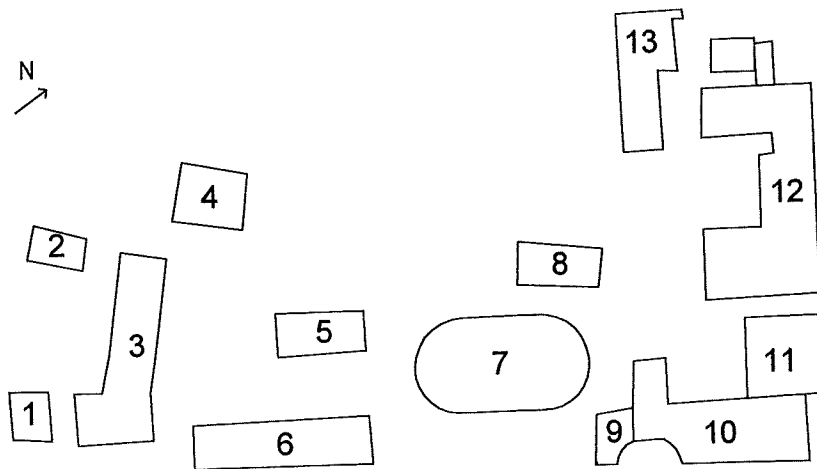

EDIFICIO N. 1

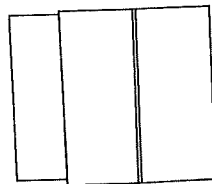
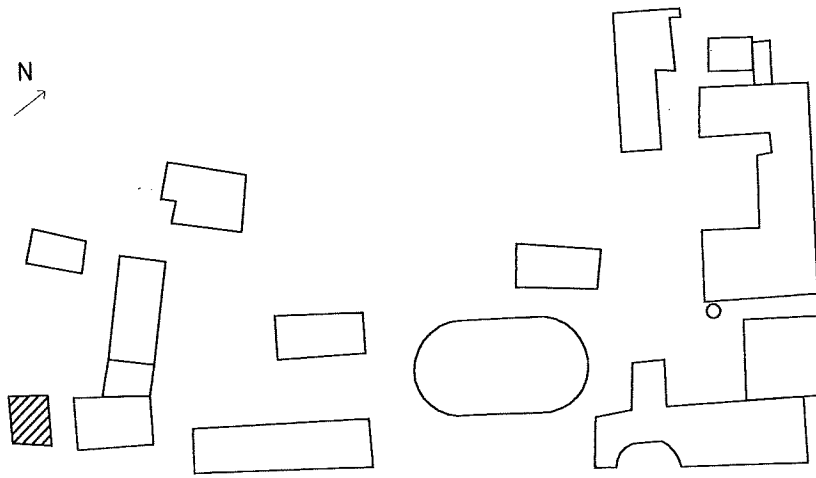

1b

1a

EDIFICIO N. 2

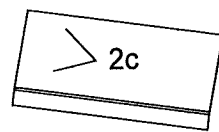
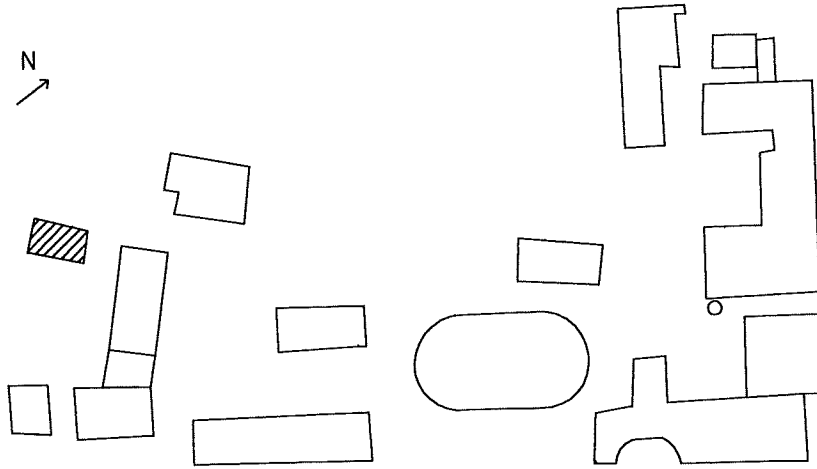

EDIFICIO N. 3

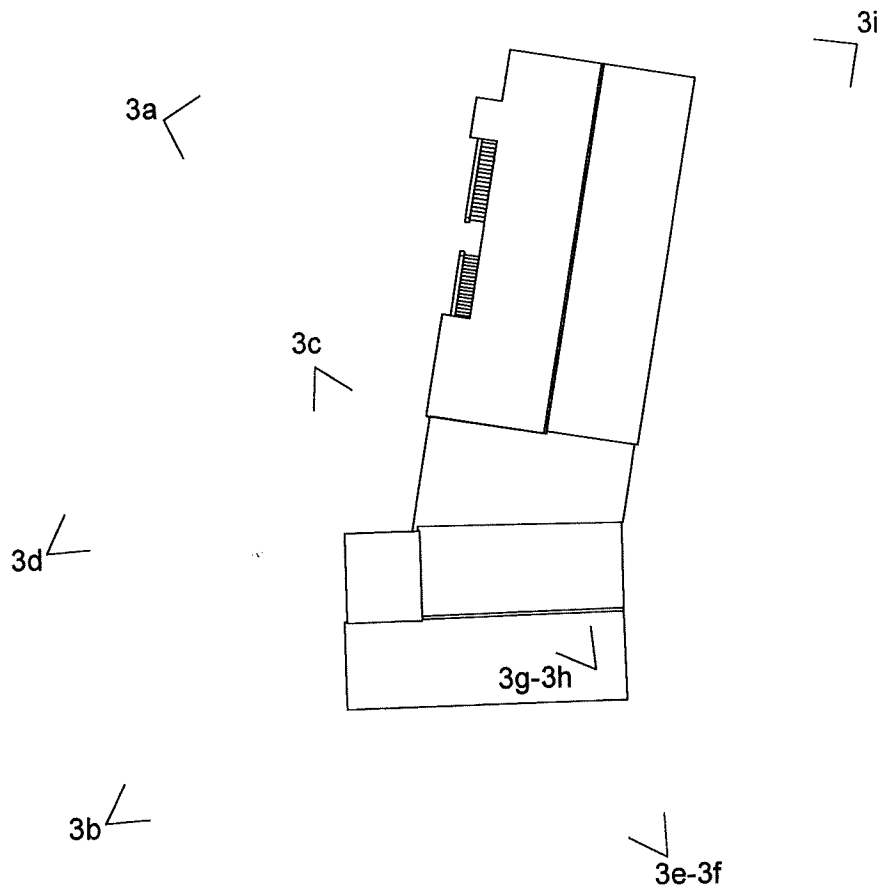
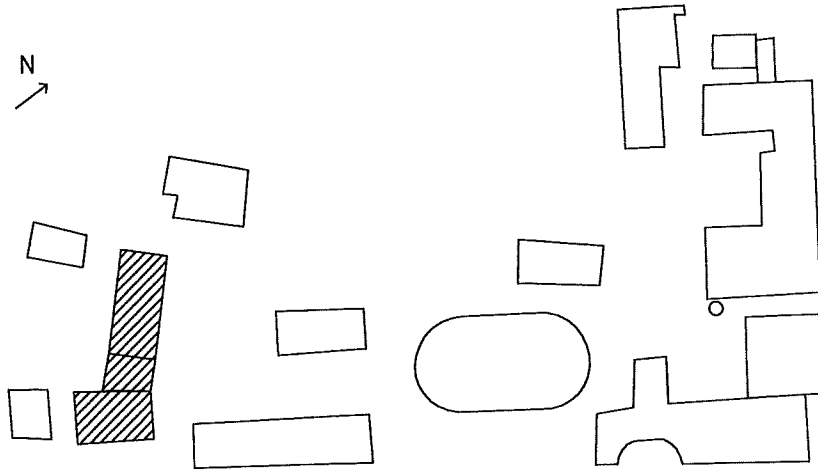

EDIFICIO N. 4

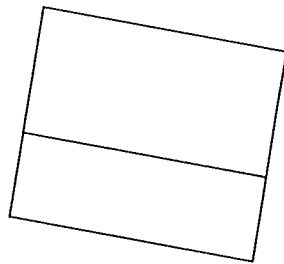
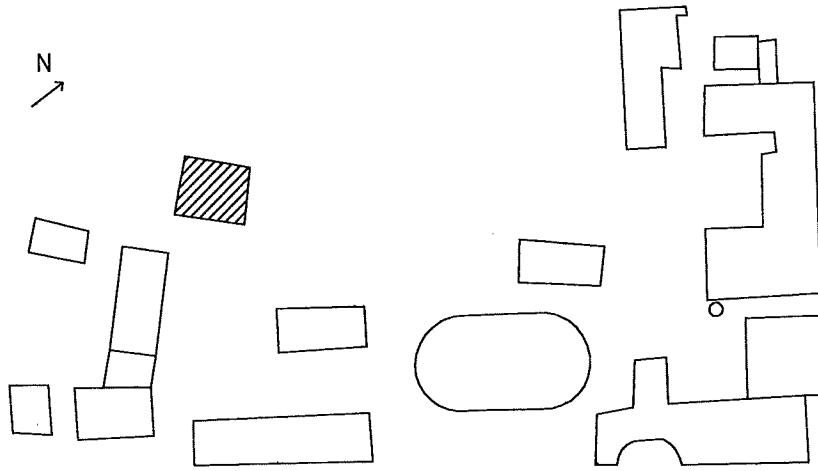

4a

EDIFICIO N. 5

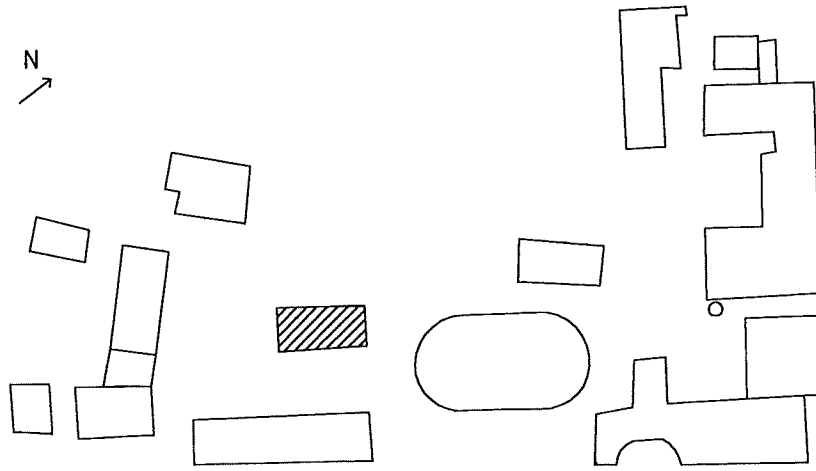

> 5a

> 5b

EDIFICIO N. 6

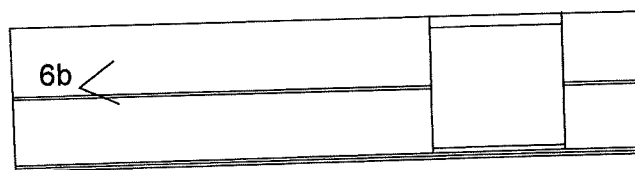
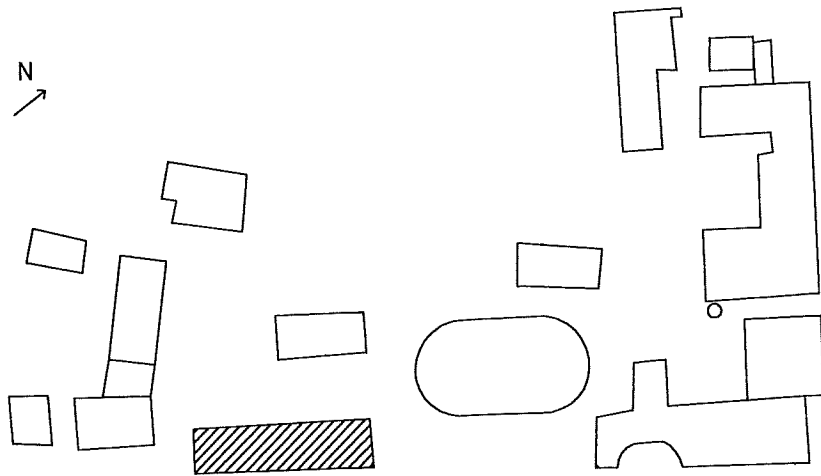

EDIFICIO N. 7

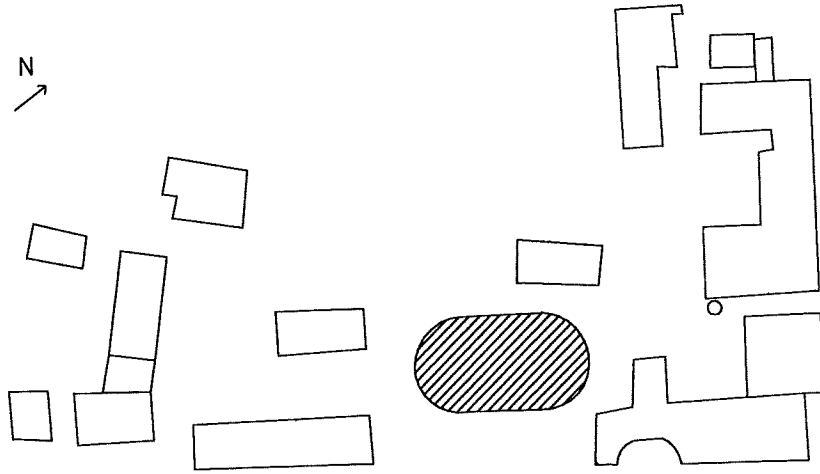

7a <

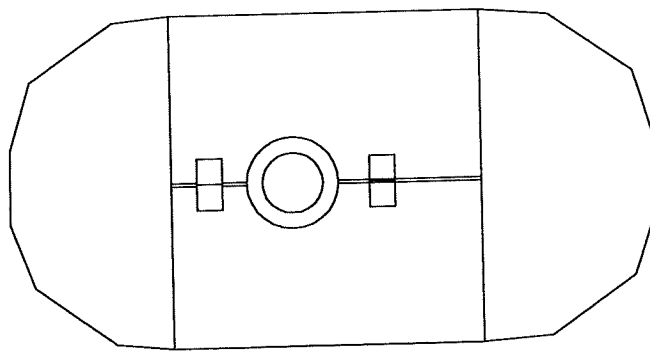

7b

EDIFICIO N. 8

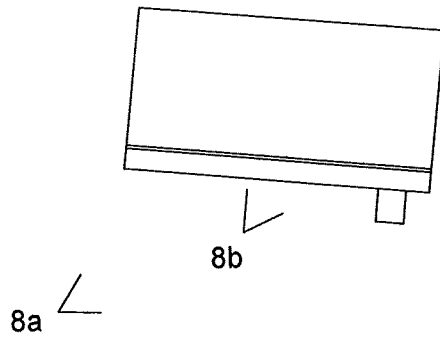
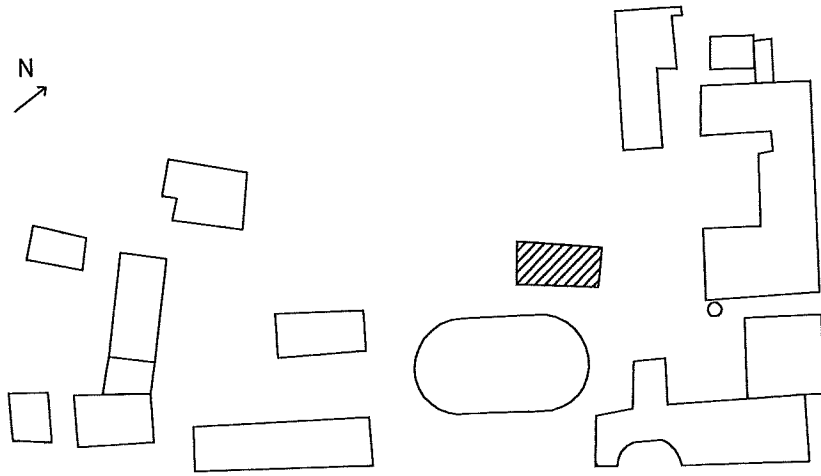

EDIFICIO N. 9

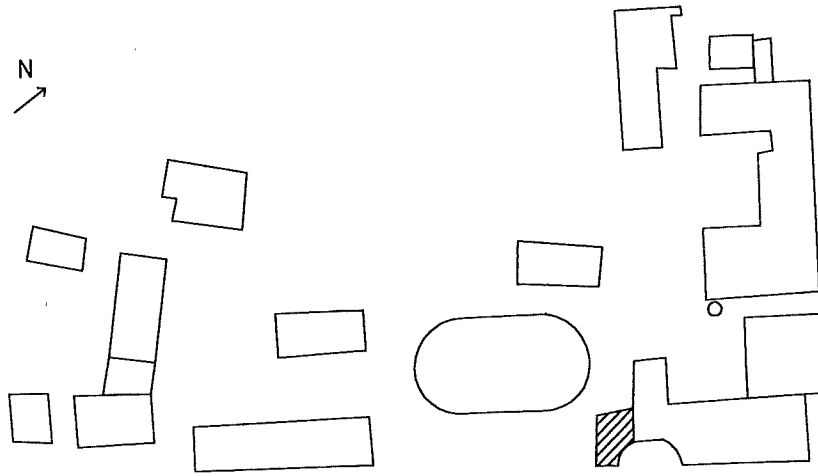

9a <

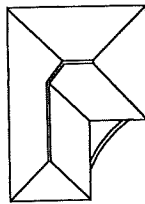

9b <

EDIFICIO N. 10

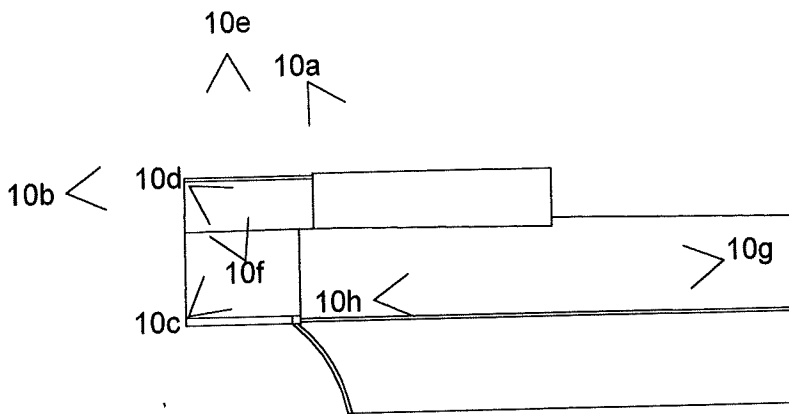
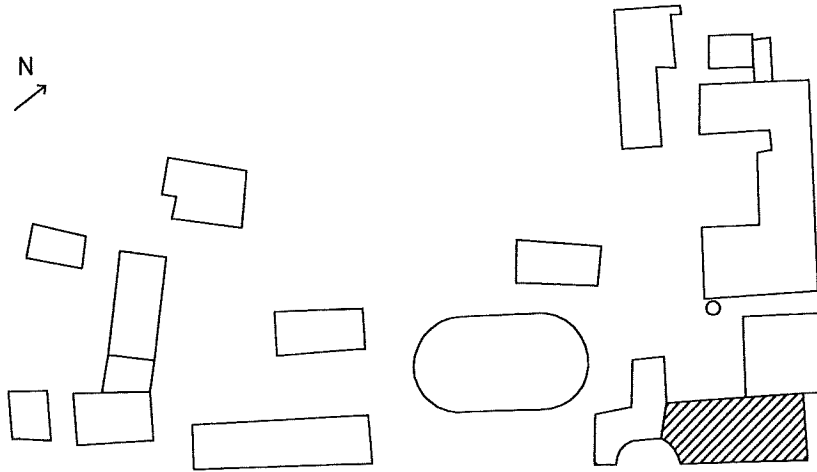

EDIFICIO N. 11

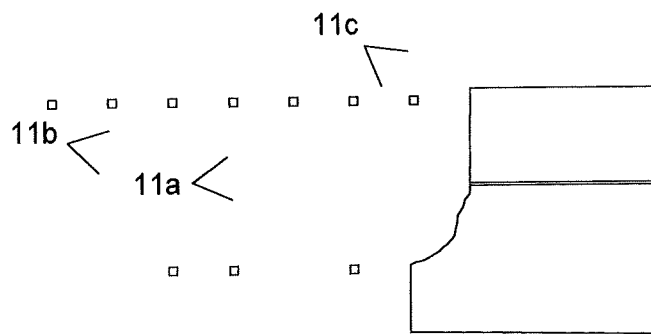
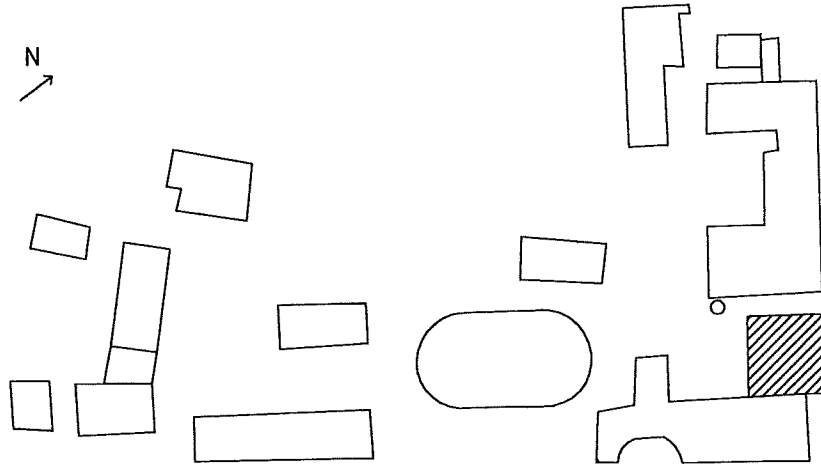

EDIFICIO N. 12

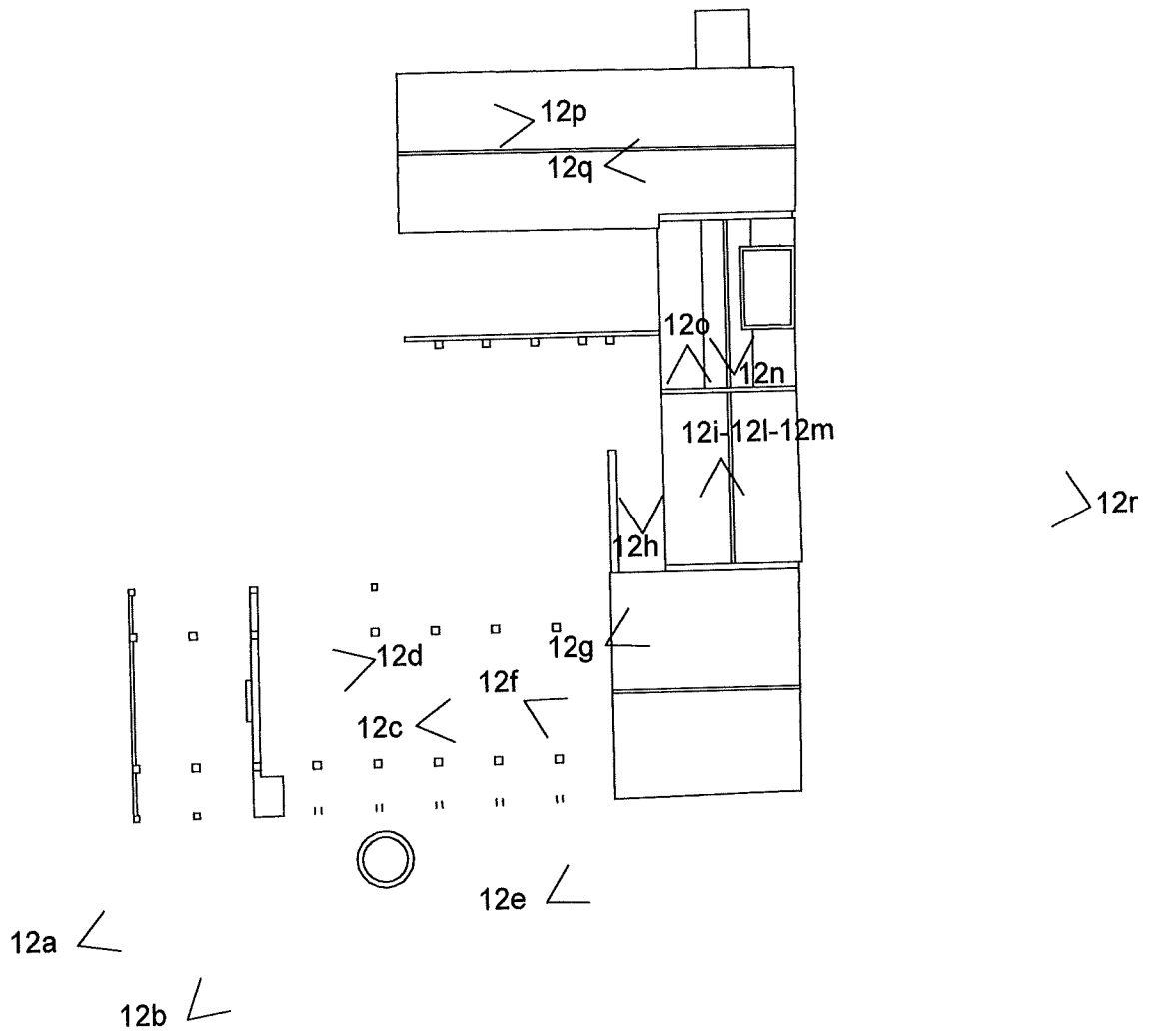
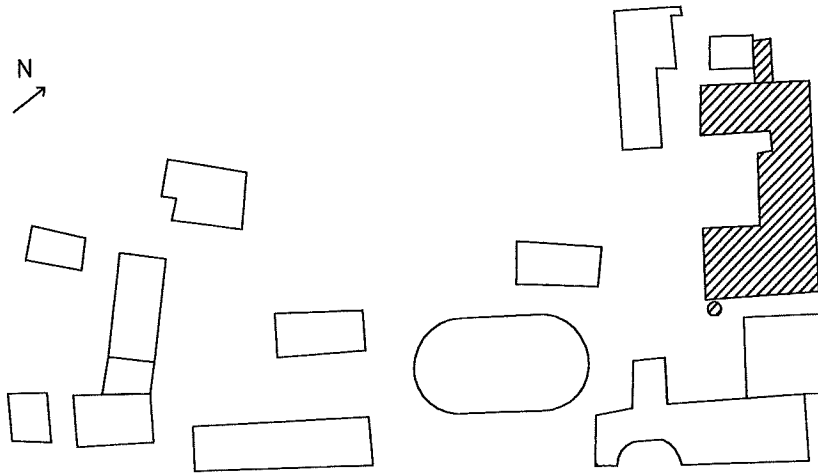

EDIFICIO N. 13

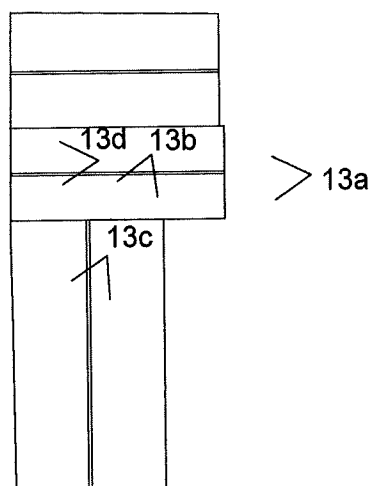
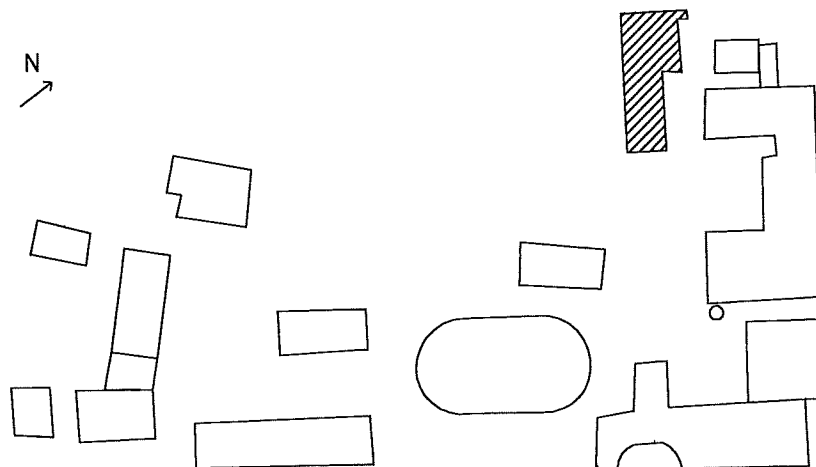



1 a



1 b



2 a



2 b



2 c





3 b



3 c





3 e



3 f



3 g



3 h





4 a

centro



5 a

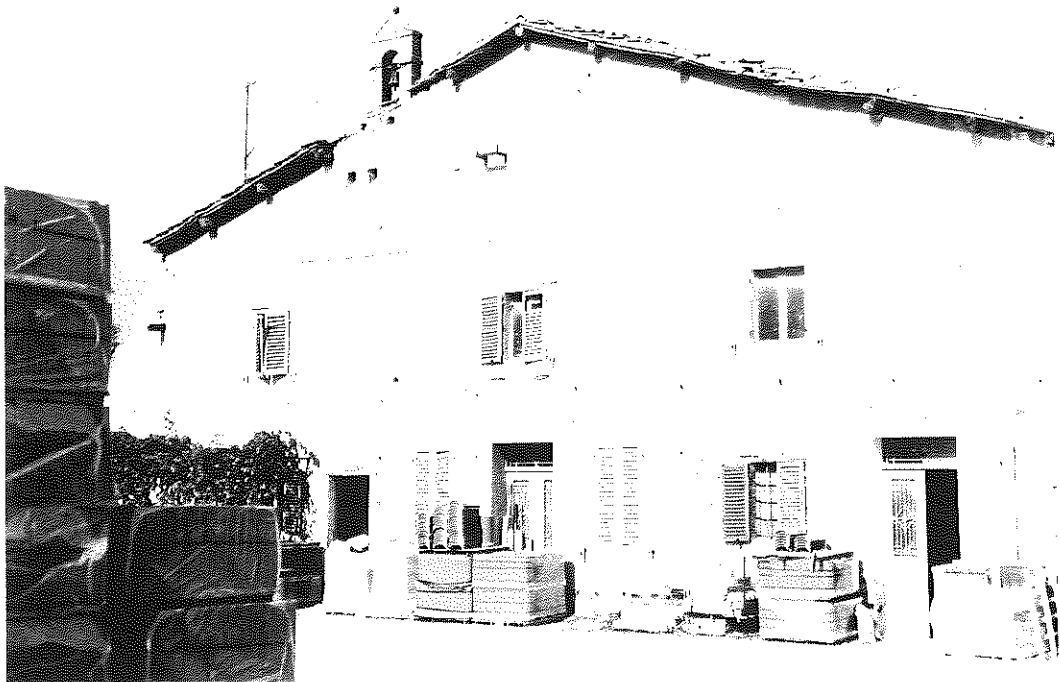

5 b

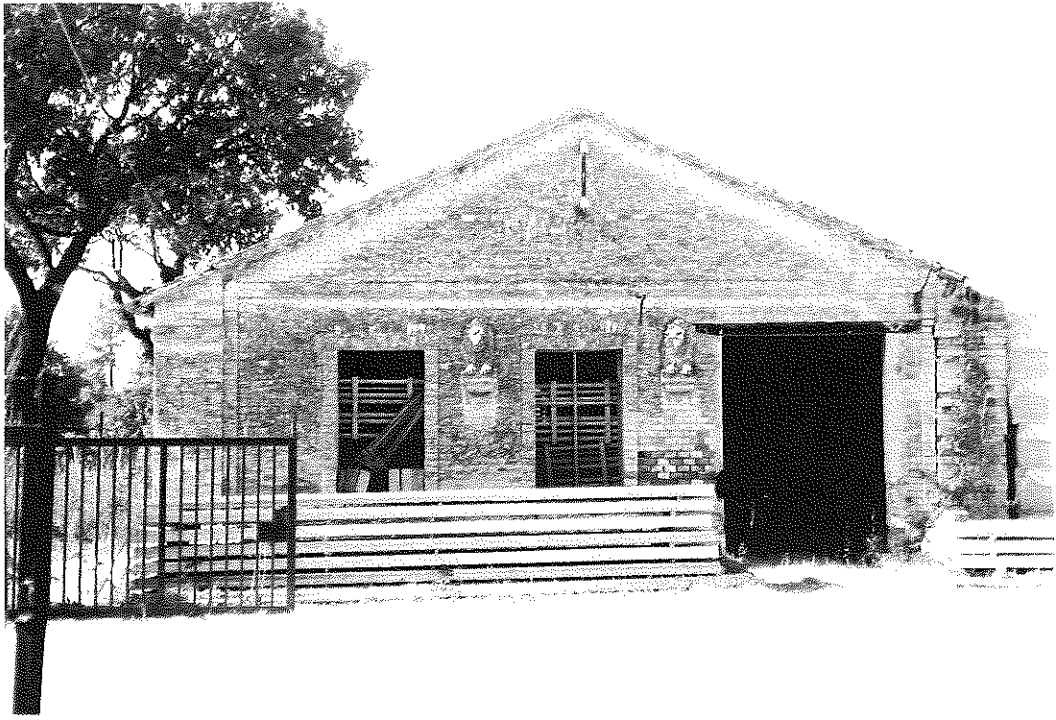

6 a



6 b



7 a



7 b



8 a



8 b



9 a



9 b



10 a



10 b



10 c



10 d



10 e



10 f



10 g



10 h



11 a



11 b



11 c



12 a



12 b



12 c



12 d



12 e

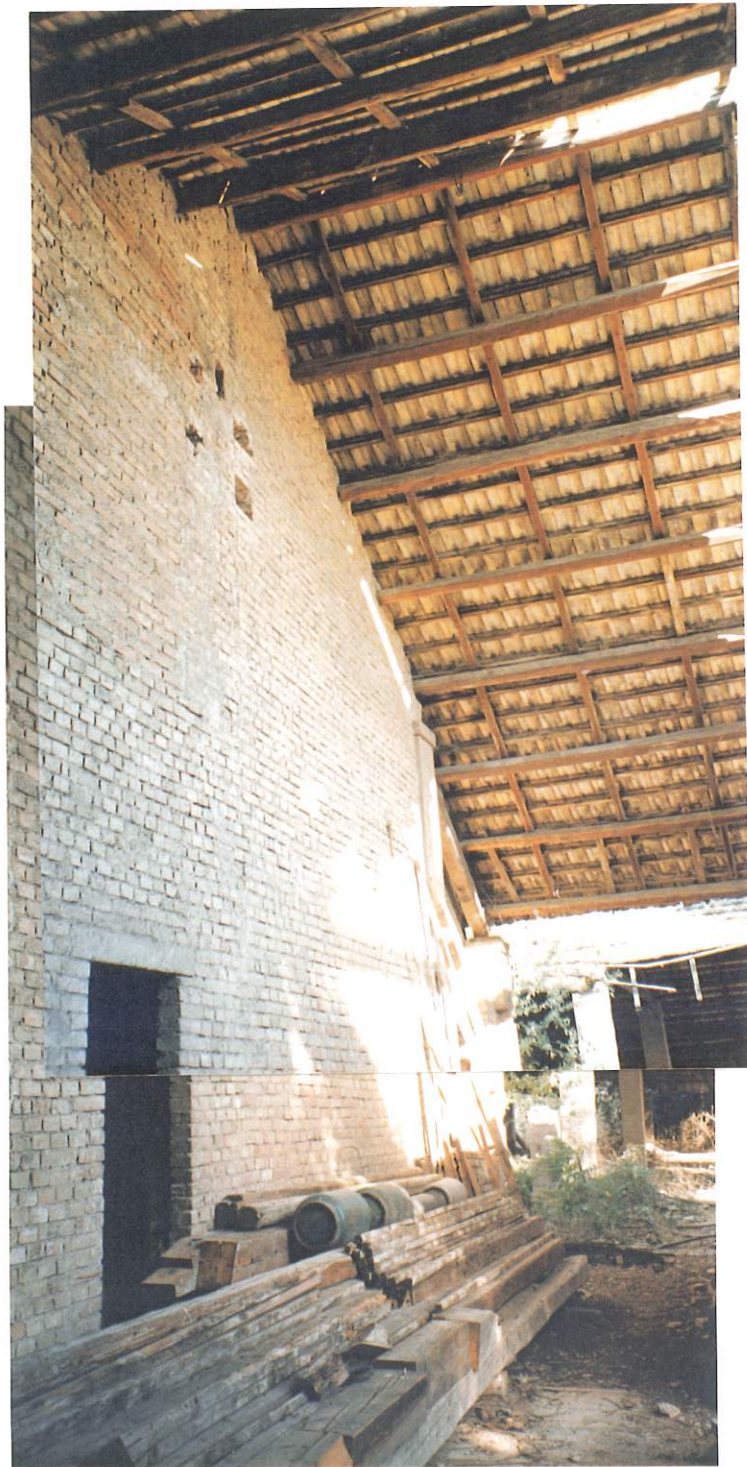

12 f



12 g

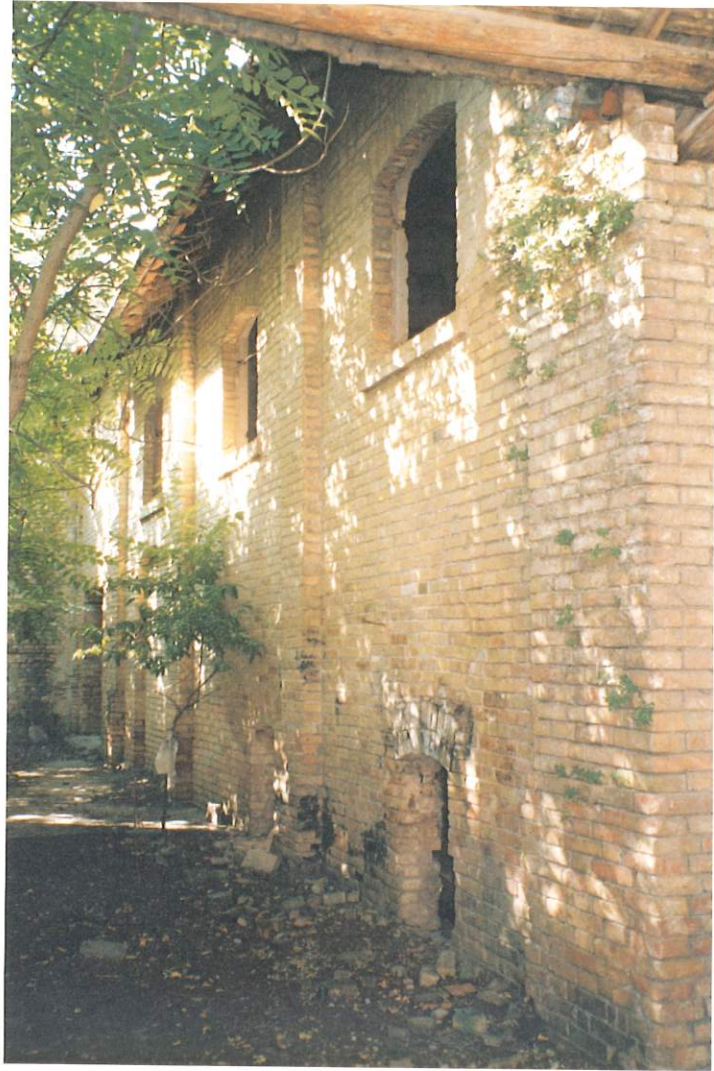

12 h



12 i



12



12 m



12 n



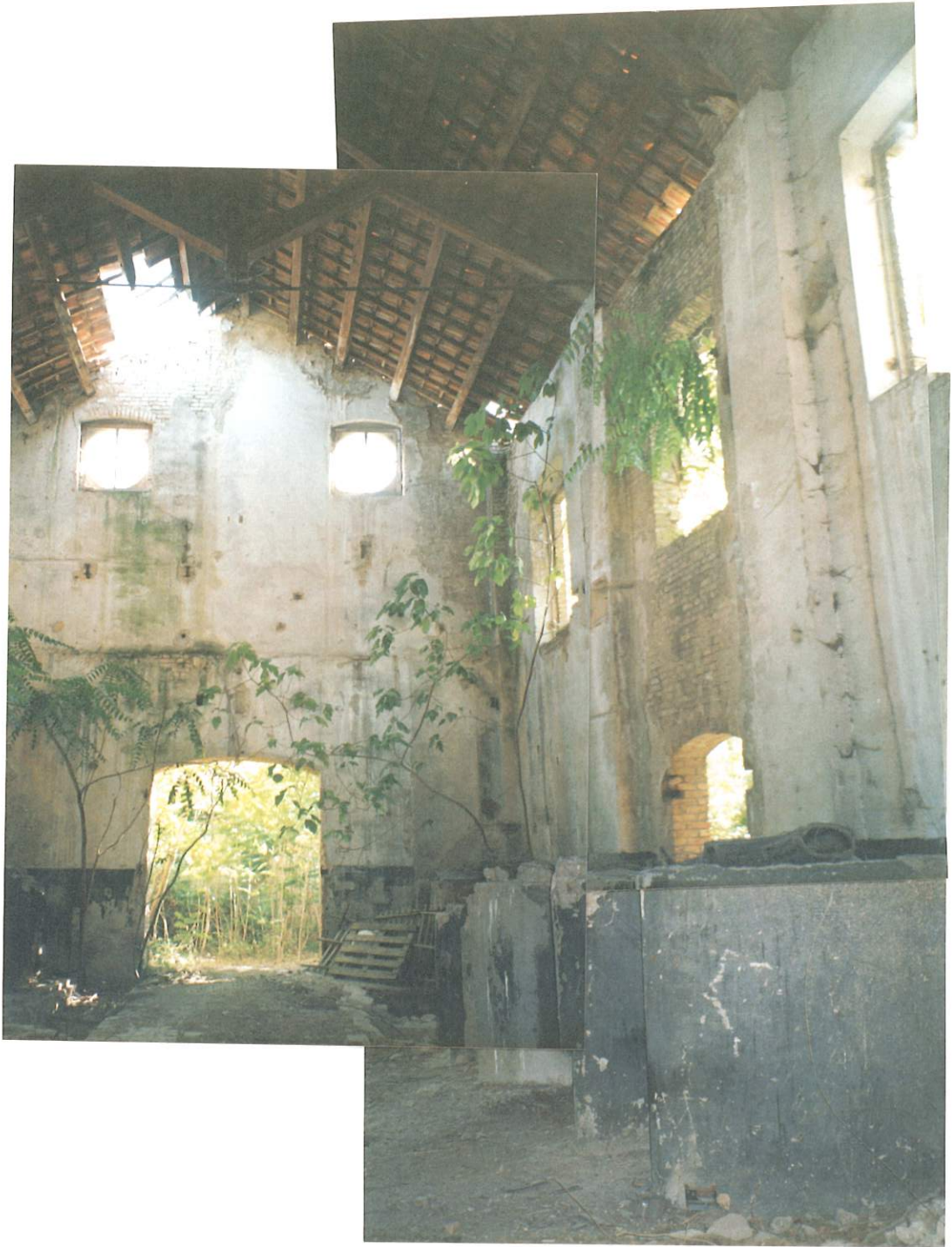



12 q



12 r



13 a



13 b



13 c



13 d